

© Government of Ireland  
OSi permit number EN-002-1006

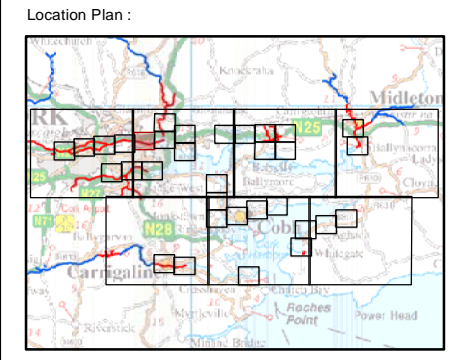
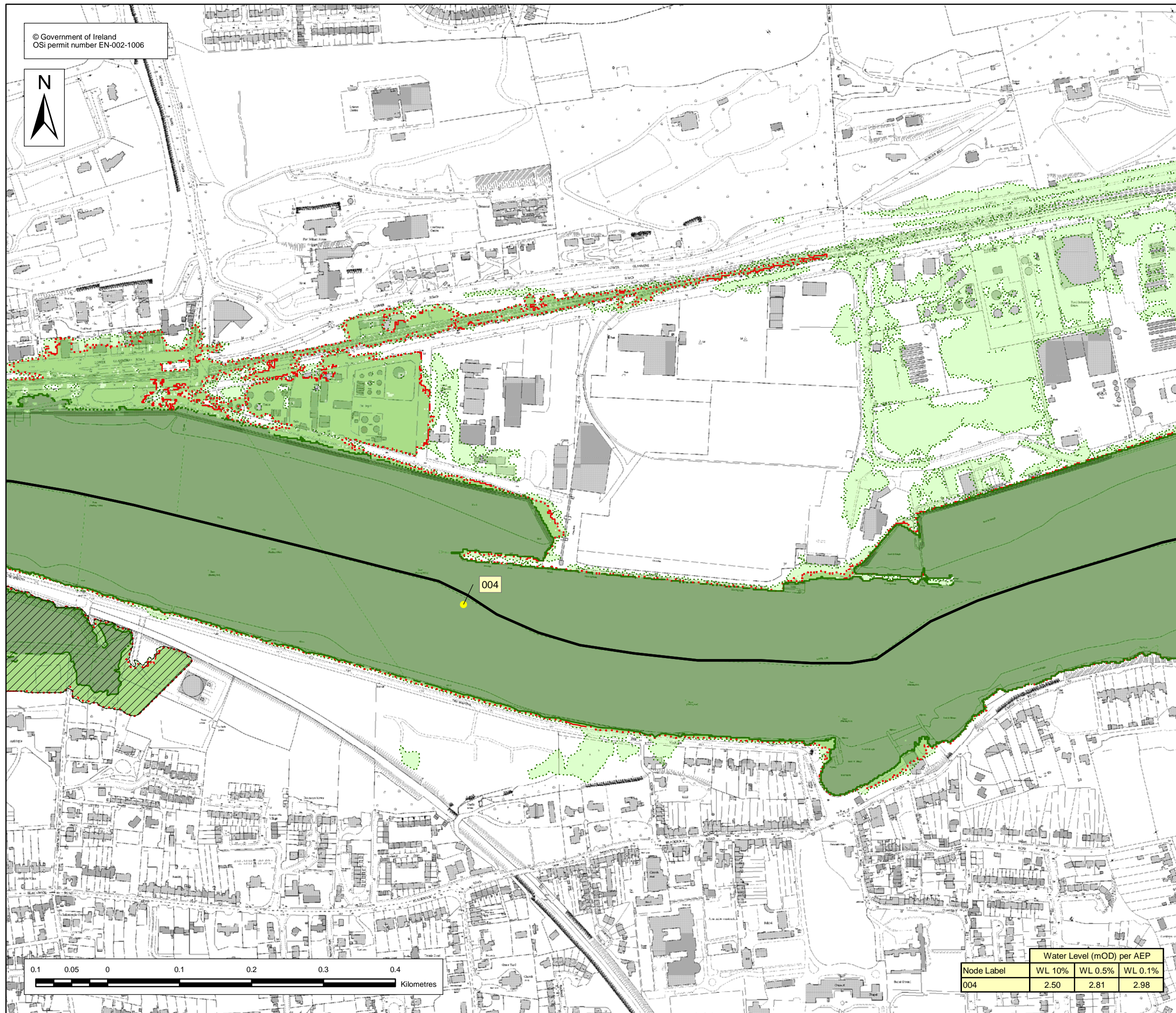

**EXTENT MAP**

- Legend:
- 10 % AEP Flood Extent  
(1 in 10 chance in any given year)
  - 0.5 % AEP Flood Extent  
(1 in 200 chance in any given year)
  - 0.1 % AEP Flood Extent  
(1 in 1000 chance in any given year)
  - Defended area
  - High Confidence (<20m) (10% AEP)
  - Medium Confidence (<40m) (10% AEP)
  - Low Confidence (> 40m) (10% and 0.1% AEP)
  - High Confidence (<20m) (0.5% AEP)
  - Medium Confidence (<40m) (0.5% AEP)
  - Low Confidence (>40m) (0.5% AEP)
  - River Centreline
  - Node Point
  - Node Label (refer to table)

USER NOTE :  
USERS OF THESE MAPS SHOULD REFER TO THE DETAILED DESCRIPTION OF THEIR DERIVATION, LIMITATIONS IN ACCURACY AND GUIDANCE AND CONDITIONS OF USE PROVIDED AT THE FRONT OF THIS BOUND VOLUME. IF THIS MAP DOES NOT FORM PART OF A BOUND VOLUME, IT SHOULD NOT BE USED FOR ANY PURPOSE.

**Halcrow**  
www.halcrow.com

Halcrow Group Ireland  
3A Eastgate Road  
Eastgate  
Little Island  
Cork  
Ireland

**OPW**

Office of Public Works  
17-19 Lower Hatch Street  
Dublin 2  
Ireland

Project :  
**LEE CATCHMENT FLOOD RISK ASSESSMENT AND MANAGEMENT STUDY**

Map :  
**CORK CITY**

Map Type : **FLOOD EXTENT**

Source : **TIDAL FLOODING**

Map area : **URBAN AREA**

Scenario : **CURRENT**

Figure By : Valeria Medina Date : 10 March 2014

Checked By : Ricardo Santaella Date : 10 March 2014

Approved By : Clare Dewar Date : 10 March 2014

Figure No. : **M9/UA/EXT/CURS/006** Revision **2**

Drawing Scale : 1:5,000 Plot Scale : 1:1 @ A3

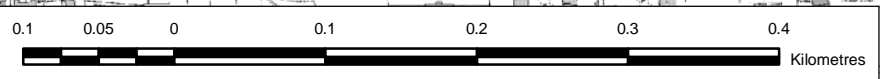

Node Label	Water Level (mOD) per AEP		
	WL 10%	WL 0.5%	WL 0.1%
004	2.50	2.81	2.98