

© Government of Ireland
OSi permit number EN-002-1006

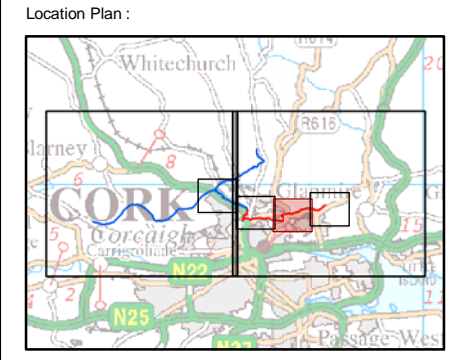
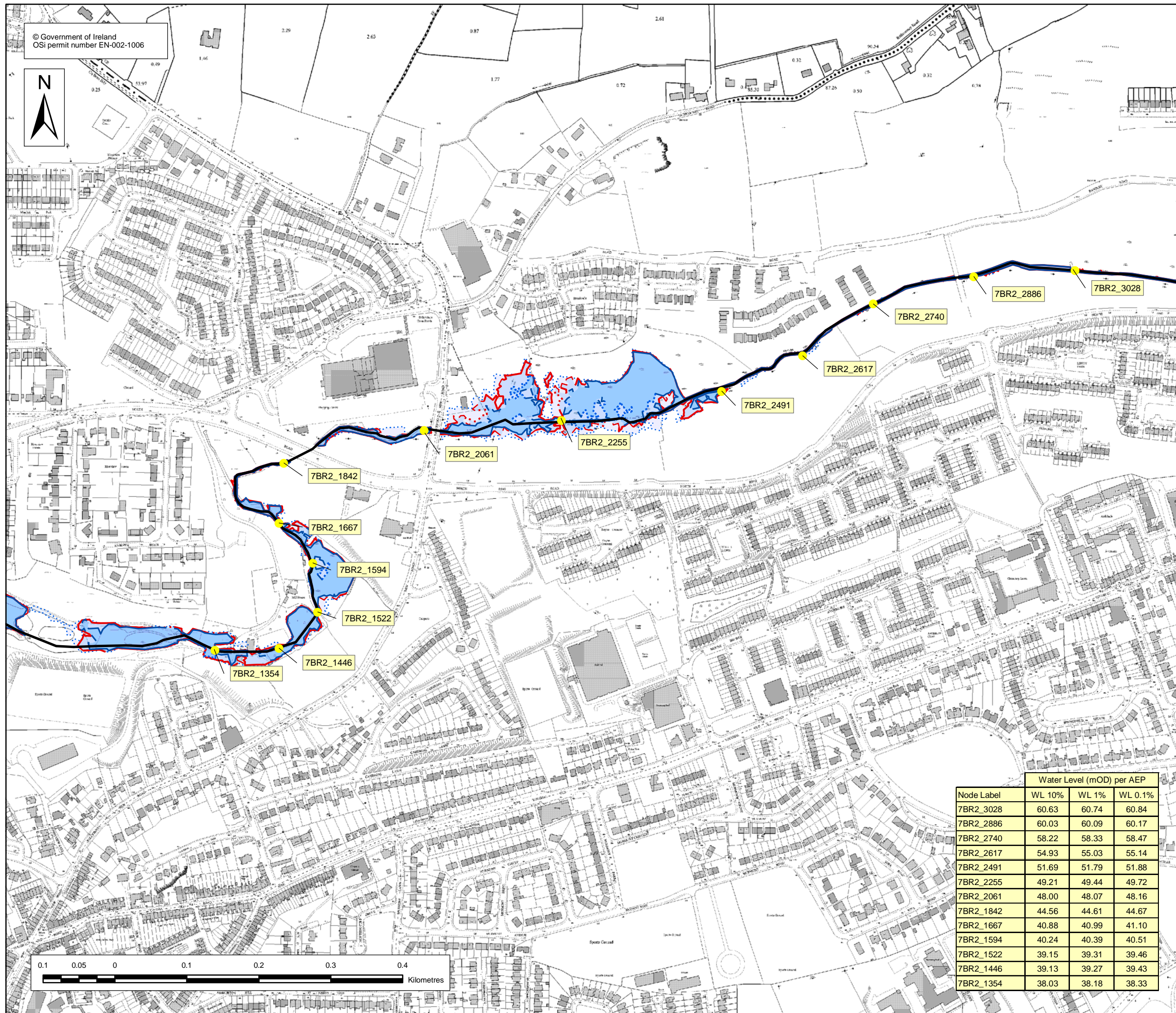

EXTENT MAP

- Legend:
- 10 % AEP Flood Extent (1 in 10 chance in any given year)
 - 1 % AEP Flood Extent (1 in 100 chance in any given year)
 - 0.1 % AEP Flood Extent (1 in 1000 chance in any given year)
 - High Confidence (<20m) (10% AEP)
 - Medium Confidence (<40m) (10% AEP)
 - Low Confidence (>40m) (10% and 0.1% AEP)
 - High Confidence (<20m) (1% AEP)
 - - - Medium Confidence (<40m) (1% AEP)
 - · - · - Low Confidence (>40m) (1% AEP)
 - River Centreline
 - Node Point
 - 7BR2_3160 Node Label (refer to table)

USER NOTE :
 USERS OF THESE MAPS SHOULD REFER TO THE DETAILED DESCRIPTION OF THEIR DERIVATION, LIMITATIONS IN ACCURACY AND GUIDANCE AND CONDITIONS OF USE PROVIDED AT THE FRONT OF THIS BOUND VOLUME. IF THIS MAP DOES NOT FORM PART OF A BOUND VOLUME, IT SHOULD NOT BE USED FOR ANY PURPOSE.

Halcrow Group Ireland
 3A Eastgate Road
 Eastgate
 Little Island
 Cork
 Ireland

Office of Public Works
 17-19 Lower Hatch Street
 Dublin 2
 Ireland

Node Label	Water Level (mOD) per AEP		
	WL 10%	WL 1%	WL 0.1%
7BR2_3028	60.63	60.74	60.84
7BR2_2886	60.03	60.09	60.17
7BR2_2740	58.22	58.33	58.47
7BR2_2617	54.93	55.03	55.14
7BR2_2491	51.69	51.79	51.88
7BR2_2255	49.21	49.44	49.72
7BR2_2061	48.00	48.07	48.16
7BR2_1842	44.56	44.61	44.67
7BR2_1667	40.88	40.99	41.10
7BR2_1594	40.24	40.39	40.51
7BR2_1522	39.15	39.31	39.46
7BR2_1446	39.13	39.27	39.43
7BR2_1354	38.03	38.18	38.33

Project :
LEE CATCHMENT FLOOD RISK ASSESSMENT AND MANAGEMENT STUDY

Map :
CORK CITY NORTH

Map Type : FLOOD EXTENT
 Source : FLUVIAL FLOODING
 Map area : URBAN AREA
 Scenario : CURRENT

Figure By : Valeria Medina Date : 21 June 2012
 Checked By : Paul Dunne Date : 21 June 2012
 Approved By : Clare Dewar Date : 21 June 2012

Figure No. : M7/UA/EXT/CURS/003 Revision : 1

Drawing Scale : 1:5,000 Plot Scale : 1:1 @ A3